

## Model MY14HY7-1 Hybrid Stepper Motor

- Low Inertia
- High Acceleration
- Thin Body
- Light Weight
- Unipolar or Bipolar Modes



### General Specifications

Step Accuracy: Maximum angular deviation is  $\pm 5\%$  of one step  
 Radial Play: Maximum 0.02mm at 450g  
 End Play: Maximum 0.08mm at 450g  
 Insulation Resistance: Minimum 100M $\Omega$  at 500V dc  
 Insulation Class: B  
 Temperature Rise: Maximum 80°C

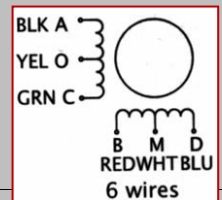

Model	Step Angle	Holding Torque (Bipolar)	No. of Leads	Phase Current	Phase Resistance	Phase Inductance	Rotor Inertia	Detent Torque	Mass	Body Length (L)
	Degree	mNm		A	$\Omega$	mH	g.cm <sup>2</sup>	mNm	g	mm
MY14HY7-1	1.8	50	6	0.40	44.0	10.0	10	8	90	20

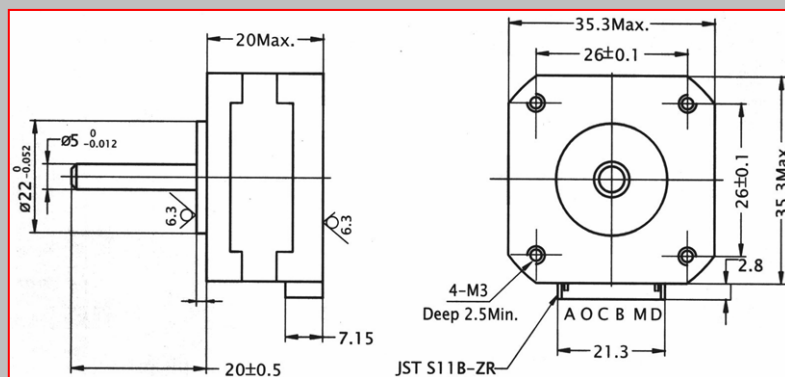

**Dimensions (mm)**